

Item	Quantity	Manufacturer	Model	Description	ELECTRICAL REQUIREMENTS		DRAIN REQUIREMENTS		DYNAMIC LOAD REQUIREMENTS			WATER REQUIREMENTS		GAS REQUIREMENTS			VENT REQUIREMENTS							
					110V/120 V/208	110V/120 V/208	Connection	Discharge (GPM)	Static Load	Dynamic Load	Unit dynamic load	Load frequency	Cold water connection	Hot water connection	Line pressure	Inlet flow rate	Gas inlet connection	Gas type	Gas pressure	Gas consumption	Vent outlet connection	Airflow	Vent area	
A	3	Sprint Queen	SS07001	Front-load washer	15A Circuit breaker	1-1/2 inch	12 GPM max	400 lbs				3/4" NH male	1/2"	34" NH male	1/2"	20-60 psi	2 x 7 GPM	2 x 3/8" NPT male	Natural	7" - 9" WC	2 x 25,000 BTU/hr	2 x 4 inch	2 x 214 CFM	4 x 25 sq ft
B	2	Sprint Queen	SS08199	Stack dryer	15A Circuit breaker			275 lbs																
C	1	Standard	EC150	88 changer	15A Circuit breaker																			
D	1	Vend Rex	494	Stack Vender																				
E	1	Salmac	TK304	Folding table																				
Total electrical demand					110 CB Amps																			
Main connection					4 inch																			
Max total discharge rate					38 GPM																			
Main cold water supply					3/4"																			
Main hot water supply					3/4"																			
Max total inlet flow rate					42 GPM																			
Provide 1-1/2 inch loop to equalize gas line pressure. Connections must comply with all applicable codes.																								
Main gas supply					3/4"																			
Total BTU input					100,000 BTU/hr																			
Total discharge					856 CFM																			
Total air consumption					5.0 CFM																			

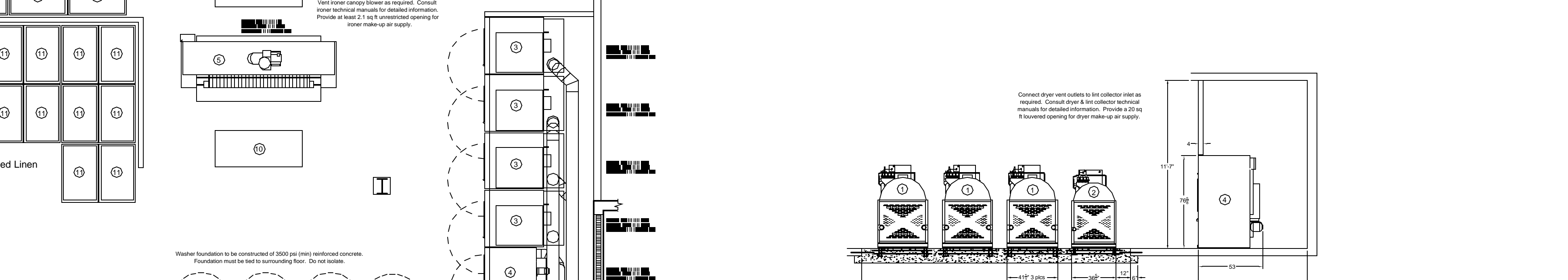

Item	Quantity	Manufacturer	Model	Description	ELECTRICAL REQUIREMENTS		DRAIN REQUIREMENTS		DYNAMIC LOAD REQUIREMENTS			WATER REQUIREMENTS		GAS REQUIREMENTS		VENT REQUIREMENTS		COMPRESSED AIR REQUIREMENTS								
					110V/120 V/208	208/60/30 3PH	Connection	Discharge rate	Static Load	Dynamic Load	Unit dynamic load	Load frequency	Cold water connection	Hot water connection	Line pressure	Inlet flow rate	Gas inlet connection	Gas type	Gas pressure	Gas consumption	Vent outlet connection	Airflow	Vent area	Air Pressure	Air consumption	
1	2	UhlMac	UW100PV	Front-load Washer	20A Circuit breaker	2 x 3 inch	85 GPM max	2744 lbs	2744 lbs	234 lbs/sq ft	10.0 Hz	2 x 3/4" NH male	1"	2 x 3/4" NH male	1"	30-85 psi	181 GPM	25 GPM	25 GPM	3/4" NPT male	Natural	7" - 9" WC	300,000 BTU/hr	10 inch	1600 CFM	3 x 95 sq ft
2	1	UhlMac	UW100PV	Front-load Washer	15A Circuit breaker	3 inch	50 GPM max	1677 lbs	2824 lbs	186 lbs/sq ft	13.6 Hz	2 x 3/4" NH male	1"	2 x 3/4" NH male	1"	30-85 psi	102 GPM	19.5 GPM	19.5 GPM	3/4" NPT male	Natural	7" - 9" WC	215,000 BTU/hr	10 inch	1100 CFM	95 sq ft
3	4	UhlMac	UT120FG	Dryer	15A Circuit breaker			1395 lbs																		
4	1	UhlMac	UT175NOM	Dryer	15A Circuit breaker			650 lbs																		
5	1	Chicago Dryer	TCL20-85	Ironer	15A Circuit breaker			4300 lbs																		
6	1	Energenics	FRP-8	Lint Collector	15A Circuit breaker			200 lbs																		
7	1	N/A	N/A	Soak Sink																						
8	1	N/A	N/A	Eyewash																						
9	2	N/A	N/A	King Size Folding Aid																						
10	6	N/A	N/A	Folding Table																						
11	1	AR	N/A	Linen Truck																						
Total electrical demand					5 CB Amps																					
Main connection					6 inch																					
Max total discharge rate					325 GPM																					
Main cold water supply					1-1/2"																					
Main hot water supply					1-1/2"																					
Max total hot water use					585 GPM																					
Max total inlet flow rate					189 GPM																					
Total BTU input					1,663,000 BTU/hr																					
Total discharge					8950 CFM																					
Total air consumption					5.0 CFM																					
Provide a 20 sq ft lowered opening for dryer & 2 sq ft open area for ironer make-up air supplies.																										
Provide 1 inch loop to equalize gas line pressure. Connections must comply with all applicable codes.																										
Air supply must be clean & dry.																										

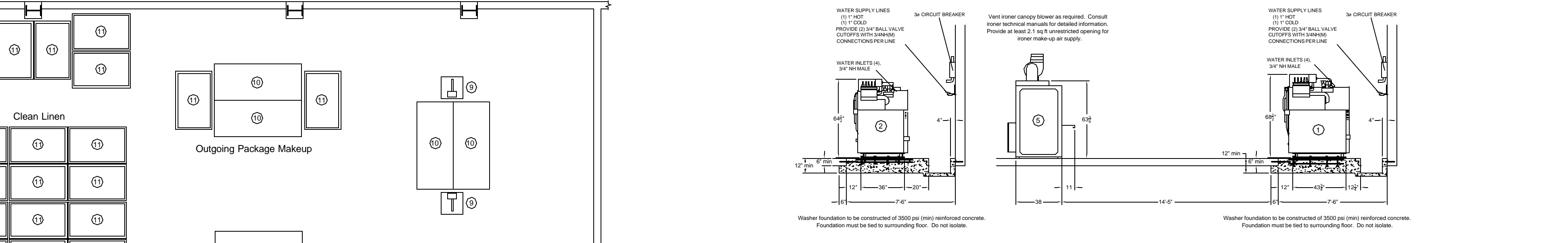
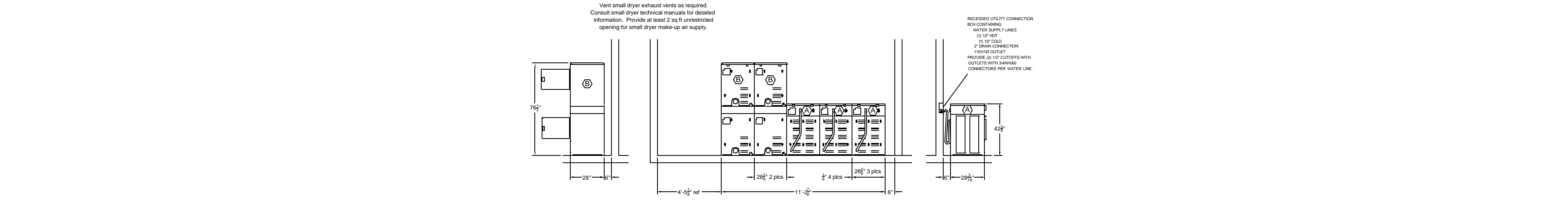
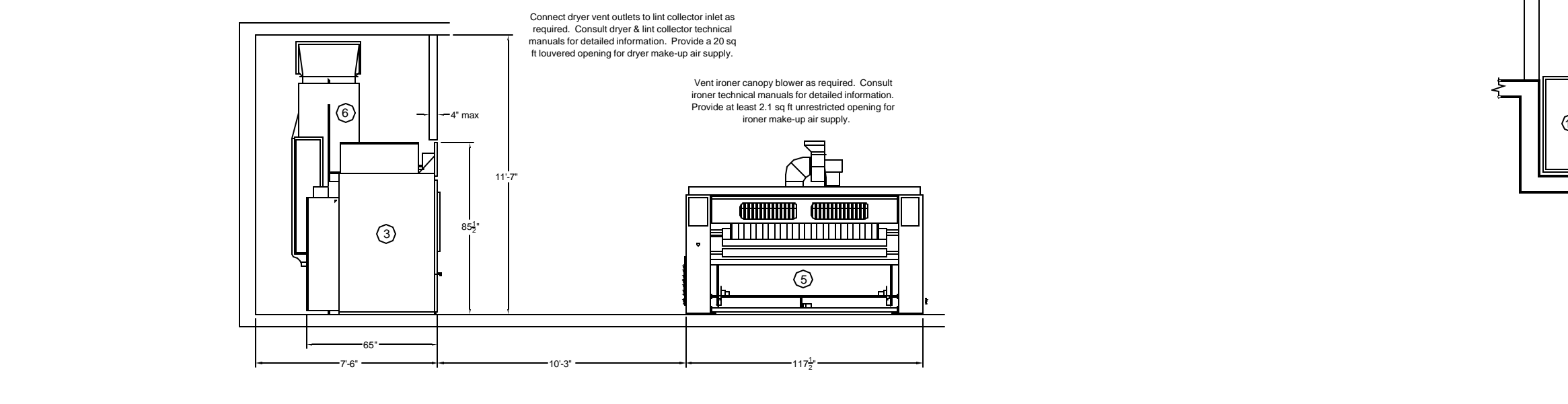
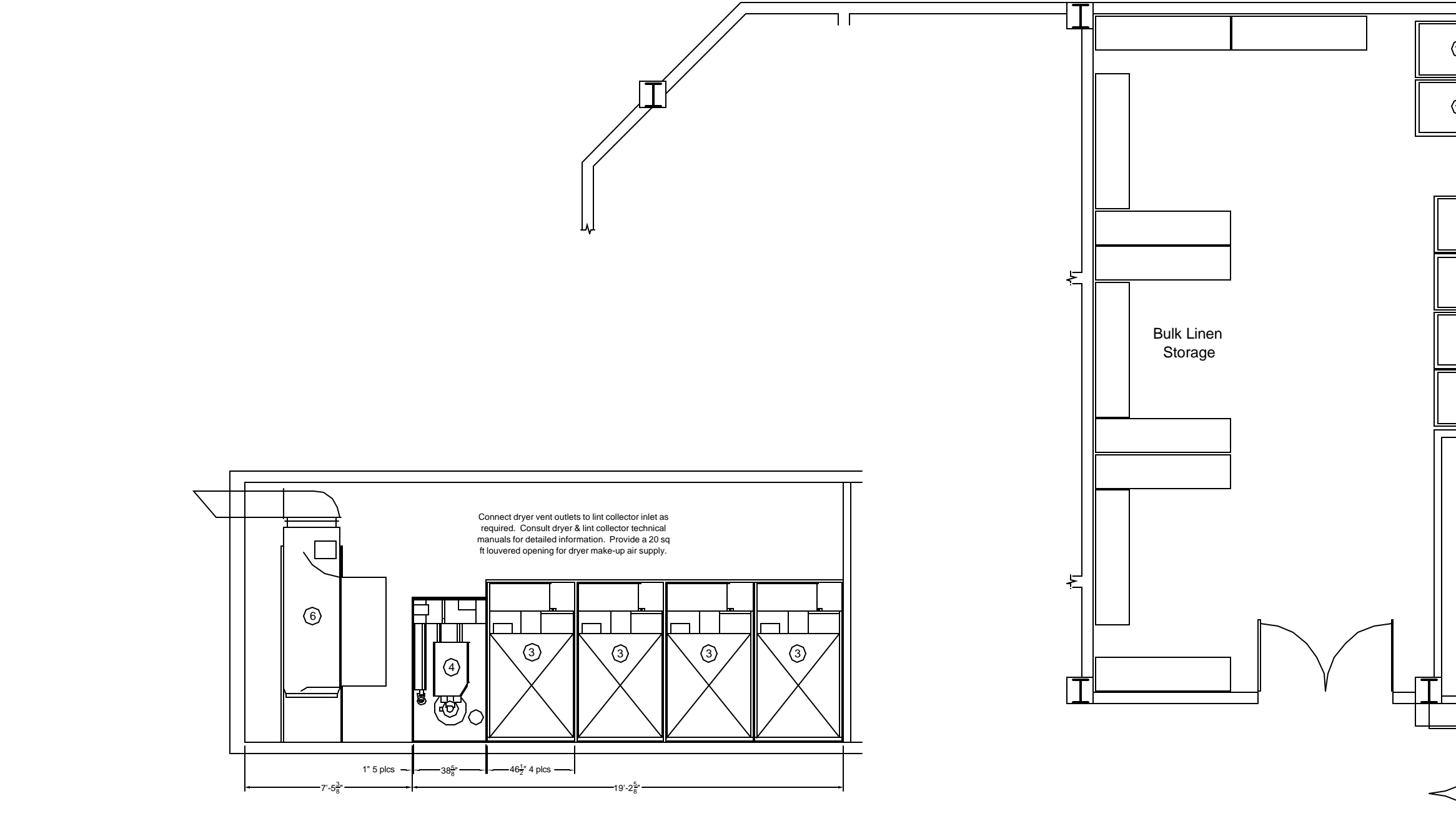
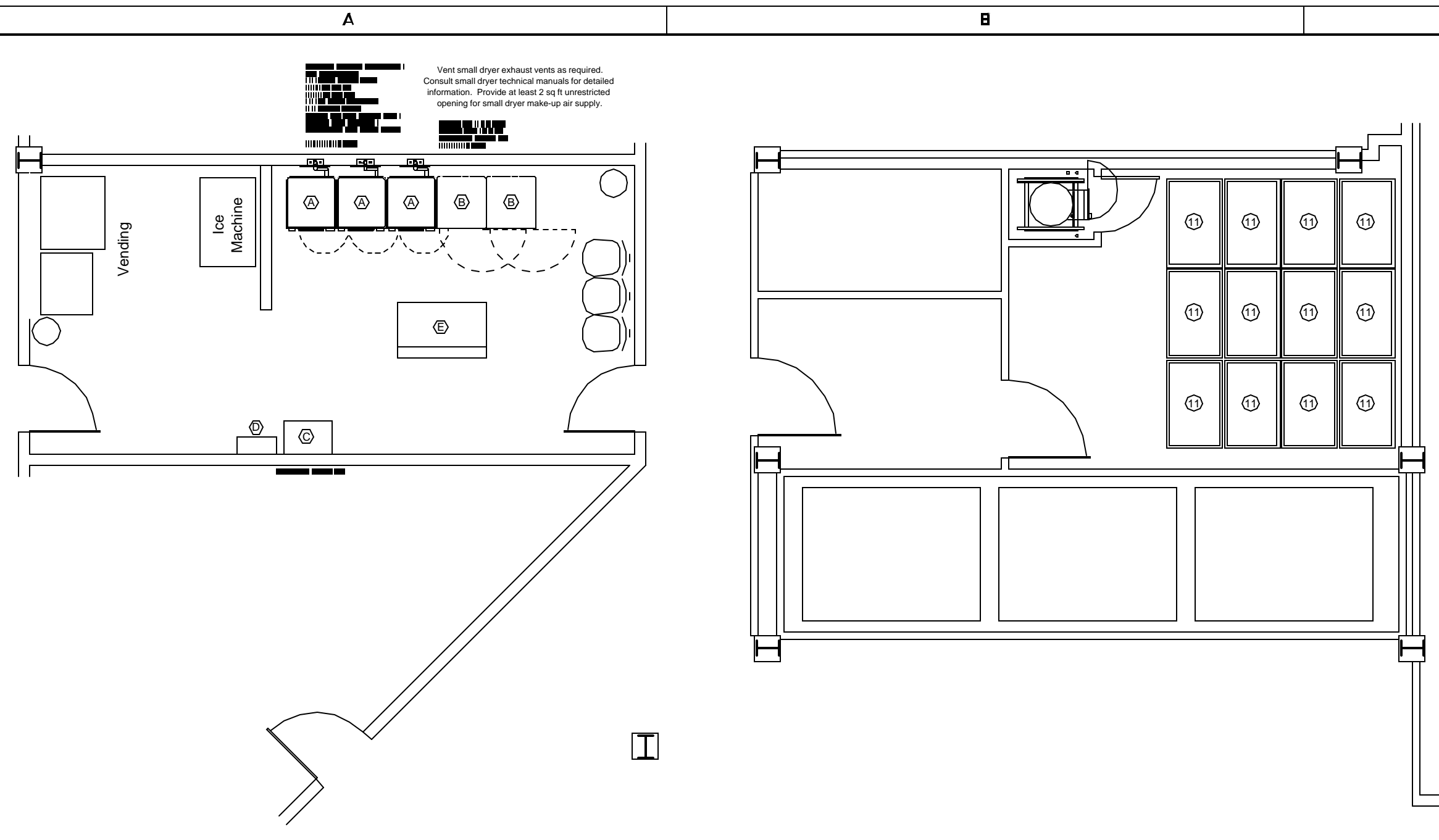
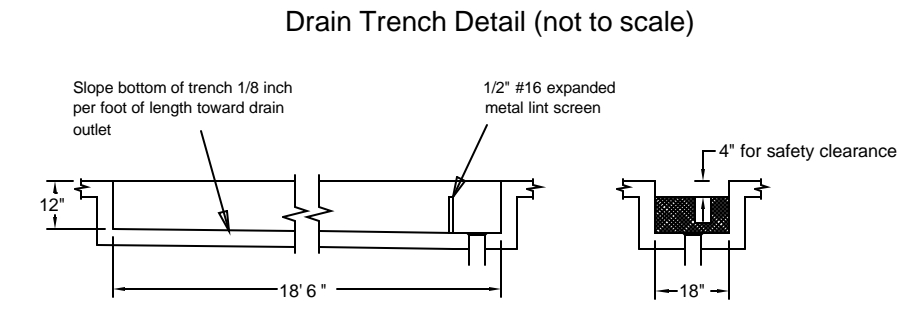

REV	DESCRIPTION	DATE	APPROVED
<b>WESTMARK FAIRBANKS</b>			
SCALE	3/16 in = 1 ft	DATE	31Jul02
DRG NO.	1013-0008	SHEET	1 OF 1